

WMT180S Temperature Transmitter



WMT180S Temperature Transmitter is a compact structure type which can be on-site installed to measure temperature and transmit corresponding signal. It consists of RTD and temperature transmitter chip that adopts two-wire output of 4~20mADC or other user specified signals for transmission. It is widely used in automatic temperature measurement and control systems such as petroleum machinery, chemical machinery, pumps and compressors, electric power, boilers, and natural gas etc.

WMT180Y temperature transmitter adopts all-stainless steel integrated processing, featuring small size, fast thermal response and can be used to measure the temperature of liquid, steam, gas and the solid surface. It is noted for their flexibility, wear resistance, vibration resistance and high temperature resistance.

Application

Equipment supporting

Automatic temperature measurement and control systems for pumps and compressors, natural gas pipeline networks, etc.

Temperature measurement of water or oil in the fields of petroleum, chemical industry, electric power, textile, environmental protection, etc.

Features

- Easy to install
- High strength, high pressure resistance
- Integrated structure
- Long-term stable work
- Fast response
- Reliable structure

Technical specification

Range: -100~450℃

Accuracy: ±0.5%

Output: 4-20mA (two-wire) or user specified

Power supply: 14-34VDC

Load: 0-100Ω (24VDC)

Humidity: 5~85%

Accuracy of module: 0.25%

Power consume: <0.5W

Long-term stability: ≤0.2%FS/year

Storage temperature: -40℃~85℃

Electrical connections: DIN43650

Protection: IP65

Model selection

WMT180	Temperature Transmitter	
-	Case type	S: Hersman connection C: Customer specified
-	Type of temperature sensor	R: RTD C: Thermocouple
-	(Temperature range)	e.g. (0-100℃) or (0-200°F) etc.
-	Material of wet parts	-S4: SS304 wet parts -S6: SS316 wet parts -O: specified
-	Signal output	S1: 4-20mA S2: 0-5V S3: 0-10V S4: RTD S5: Thermocouple S0: customer specified
-D	Display	1: Without 2: LED 3: LCD
-A	Installment type	1: fixed thread 2: slide adjustable thread 3: rotatable adjustable thread 4: flange 5: clamp 0: customer specified
	Thermo well	None: without TW: with thermo well
-	Size of installment	e.g. for A1, -1/2BSP or -M20*1.5 etc.; for A3, -2" or 3" etc.
-	(Diameter of Probe)	E.g. -6 (6mm), or -1/4". etc.
-	(Length of Probe)	E.g. -200 (200mm), or -8". etc.

With display:



With bellow for high temperature:



Thermowell:



Dimension:

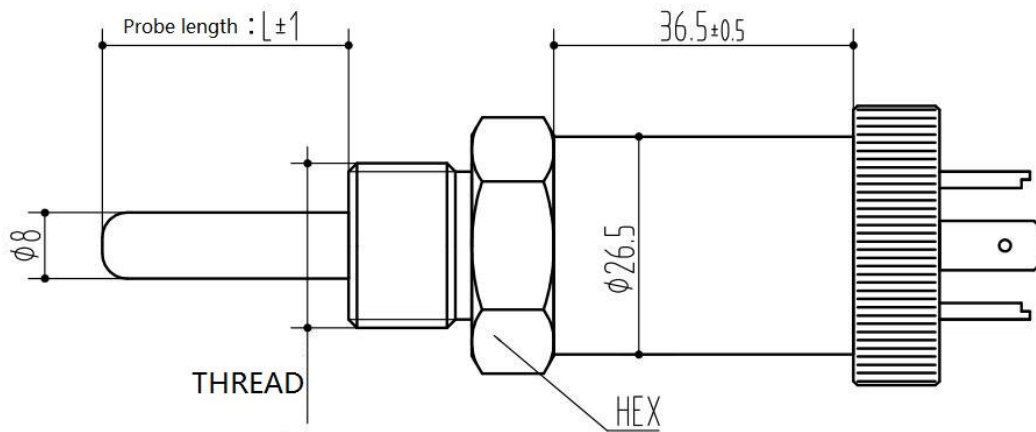

Wiring:

